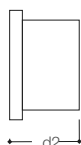
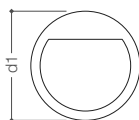

ZESS

Last information update: March 2020

wall recessed luminaire $\varnothing = 105$ mm - Warm White - 80 CRI

Product code
07201-122

Technical description

Track light made of die-cast aluminium; surface powder coated in white or black; spotlight head 355° rotatable and 90° tiltable; converter integrated in the power track adapter; COB (Chip on Board) technology for maximum efficiency; no multiple shadows; energy-efficient LEDs with very good colour rendering; binning initial ≤ 3 MacAdam; available in the light colours 3000K and 4000K; CRI ≥ 90 ; min. 85% of the luminous flux after 50000 hours; high-quality, aluminium, vapour deposition coated reflector with faceted lens design; precise radiation characteristic with four different beam angles; good glare reduction due to recessed light point plane; optical attachments available as accessories; degree of protection IP 20; PC I; adapter for toolless insertion or movement on a variety of 4-phase power tracks; optionally non-dimmable or DALI-2 control

Installation

Recessed box to be installed flush with the horizontal surface, the luminaire is push-in fit in the recessed box.

Dimension (mm)
105 (d1) x 75 (d2)

Colour
Black / White

Weight (Kg)
0.245

Mounting
Wall recessed

Wiring

Product inclusive of 85-240 VAC internal electronic control gear (Phase dimmable, DALI versions separately ordered).

Notes

Ip65 degree of protection on the product.

Complies with EN60598-1 and pertinent regulations



The lighting fixtures were designed and tested to withstand ambient temperature upto 55 degree, longer run in increased temperatures may cause damage or degradation of the luminaire.

Product configuration: 075201-122

Product characteristics

Total lighting output [Lm]: 109

Total power [W]: 3.1

Luminous efficacy [Lm/W]: 34.5

Life Time: 45,000h - L80 - B10 (Ta 35°C)

Ambient temperature range: from -20°C to +50°C. (*)

Voltage [V]: 220 - 240

Life Time: 60,000h - L70 - B10 (Ta 25°C)

Number of optical assemblies: 1

Power factor (pf): 0.5

* Preliminary data, lumen output may differ according to co-relative colour temperature.

Optical assembly Characteristics

Type 1

Light Output Ratio (L.O.R.) [%]: 42

Lamp code: DURIS S

ZVEI Code: LED

Nominal power [W]: 2.6

Nominal luminous [Lm]: 260

Lamp maximum intensity [cd]: /

Beam angle [°]: /

Number of optical assembly: 1

Ballast Efficiency [%]: 86

Ballast losses [W]: 0.5

Colour temperature [K]: 3000

CRI: 80

Current draw [mA]: 120

MacAdam Step: 3